

Notes:

1. Material: PA66 UL94 V2;
2. Color: Natural;
3. Male (M2) Torques:  $\cong 0.06$  Nm;      Male (M2.5) Torques:  $\cong 0.08$  Nm;  
     Male (M3) Torques:  $\cong 0.13$  Nm;      Male (M4) Torques:  $\cong 0.3$  Nm;  
     Male (M5) Torques:  $\cong 0.58$  Nm;      Male (M6) Torques:  $\cong 0.8$  Nm;  
     Male (M8) Torques:  $\cong 2.5$  Nm;      Male (M10) Torques:  $\cong 5.0$  Nm;
4. RoHS Compliant.

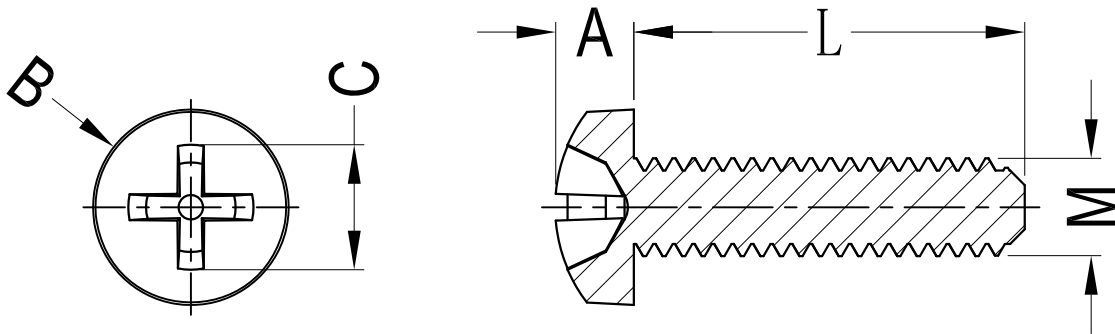

Part No. Article No.	length																				A	B	C	
	4.0	4.5	5.0	6.0	6.5	8.0	10.0	12.0	15.0	16.0	20.0	22.0	25.0	30.0	35.0	40.0	45.0	50.0	60.0					
GCRS-7045-M2-L	50019		50020	50021		50022	50023	50024		50025	50026		50027								1.6	Ø4.0	1.9	
GCRS-7045-M2.5-L	50551	50044	50553	50045		50046	50047	50048		50049	50050		50051								2.1	Ø5.0	2.7	
GCRS-7045-M3-L	50076		50077	50078		50079	50080	50081		50082	50083		50084	50085	50086	50087					2.4	Ø5.6	3.0	
GCRS-7045-M4-L	50518			50118		50119	50120	50121	50418	50122	50123		50124	50125		50126					3.1	Ø8.0	4.4	
GCRS-7045-M5-L				50156		50157	50158	50159		50160	50161		50162	50163		50164				50165	3.7	Ø9.5	4.9	
GCRS-7045-M6-L			50202	50203	50204	50205	50206	50207		50208	50209	50438	50210	50211		50212				50213	50214	4.6	Ø12.0	6.9
GCRS-7045-M8-L						50657	50391	50392		50393	50394		50395	50396	50397	50398	50399	50400				5.8	Ø16.0	9.0
GCRS-7045-M10-L										50402	50403		50404	50405								7.5	Ø20.0	10.1

**Gecko International Co.**

DATE

2022-1-6

DIMENSION

TOLERANCE

TITLE

CROSSED NYLON METRIC SCREW

SCALE

FIT

$L \leq 4$

$\pm 0.10$

ARTICLE NO.

GCRS-7045

MOLD NO.

/

DRAW

JF

UNIT

MM

$4 < L \leq 15$

$\pm 0.20$

PART NO.

SEE TABLE

MATERIAL

SEE NOTES

DESIGN

JF

VERSION

A0

$15 < L \leq 50$

$\pm 0.30$

DWG NO.

E5003

COLOR

SEE NOTES

APPROVAL

FDL

VIEW

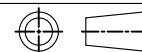

$50 < L \leq 100$

$\pm 0.40$