

REV	DESCRIPTION	DATE	CHECK
A1	①3.45 Change to 3.7; ②4.2 Change to 4.6; ③Ø9.8 Change to Ø9.5;	2016-7-14	FDL

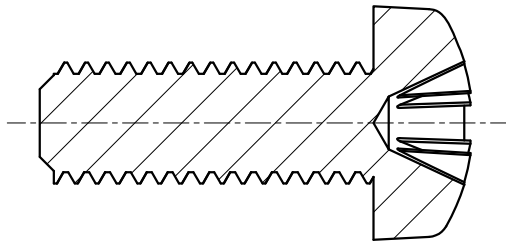
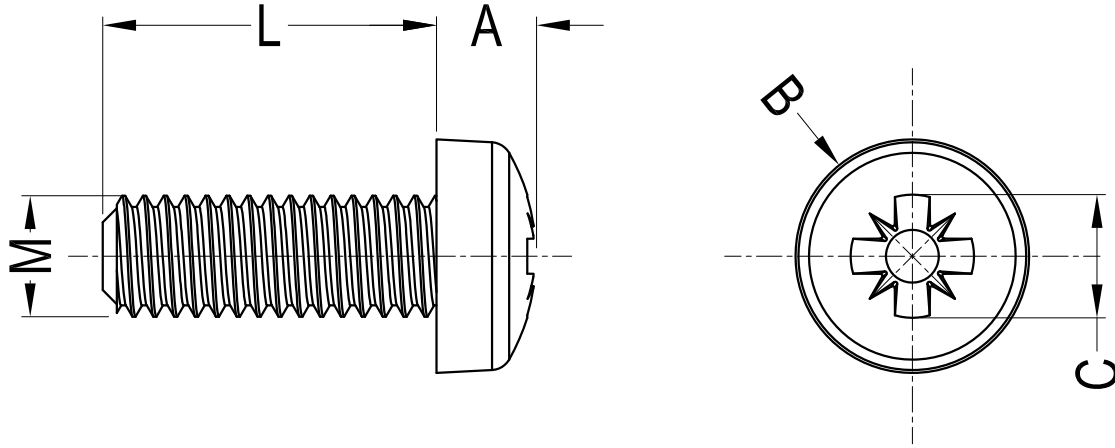

Notes:

1. Material: PA66 UL94 V2;
2. Color: Natural;
3. Male (M3) Torques: $\cong 0.13$ Nm;
Male (M4) Torques: $\cong 0.3$ Nm;
Male (M5) Torques: $\cong 0.58$ Nm;
Male (M6) Torques: $\cong 0.8$ Nm;
Male (M8) Torques: $\cong 2.5$ Nm;
4. RoHS Compliant.

Part No. Article No.	length																			A	B	C
	4.0	5.0	6.0	6.5	8.0	10.0	12.0	15.0	16.0	20.0	22.0	25.0	30.0	35.0	40.0	45.0	50.0	60.0				
GCHROHS-34812-M3-L	50088	50089	50090		50091	50092	50093		50094	50095		50096	50097	50098	50099					2.3	Ø5.6	2.8
GCHROHS-34812-M4-L	50515		50127		50128	50129	50130	50556	50131	50132		50133	50134		50135					3.1	Ø8.0	4.3
GCHROHS-34812-M5-L			50166		50167	50168	50169		50170	50171		50172	50173		50174		50175			3.7	Ø9.5	4.7
GCHROHS-34812-M6-L		50215	50216	50217	50218	50219	50220		50221	50222	50559	50223	50224		50225		50226	50227		4.6	Ø12.0	6.7
GCHROHS-34812-M8-L					50716	50641	50642		50643	50644		50645	50646	50647	50648	50649	50650			6.0	Ø15.8	8.8

Gecko International Co.

Gecko International Co.						DATE	2022-1-6	DIMENSION	L \leq 4	TOLERANCE	± 0.10
TITLE	CROSS RECESSED OVAL HEAD SCREW					SCALE	FIT				
ARTICLE NO.	GCHROHS-34812	MOLD NO.	/	DRAW	JF	UNIT	MM	4 < L \leq 15		± 0.20	
PART NO.	SEE TABLE	MATERIAL	SEE NOTES	DESIGN	JF	VERSION	A1	15 < L \leq 50		± 0.30	
DWG NO.	E5010	COLOR	SEE NOTES	APPROVAL	FDL	VIEW		50 < L \leq 100		± 0.40	